

SRF 2013- Paris, September 23-27th

XFEL Coupler infrastructure at LAL

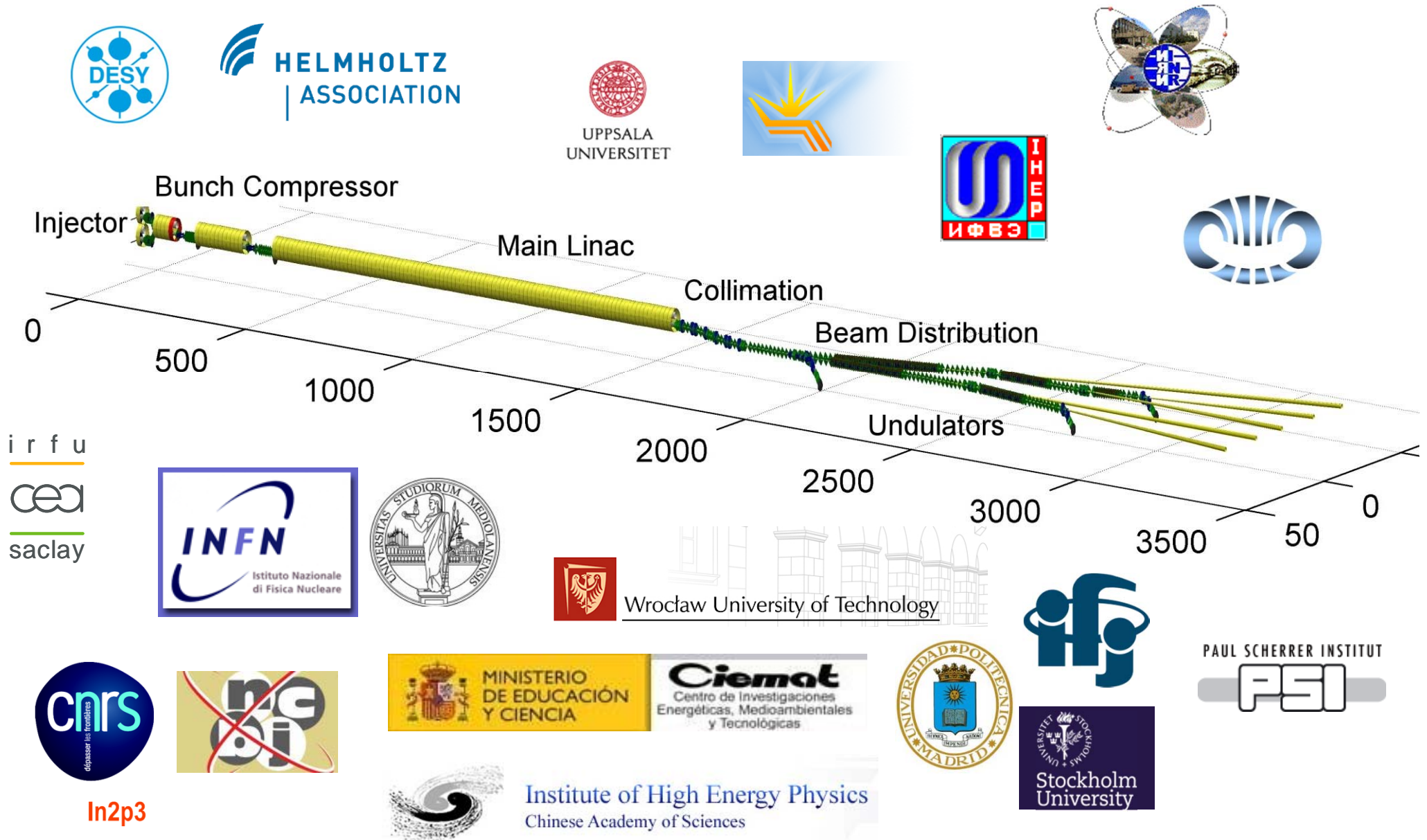

XFEL Coupler infrastructure at LAL





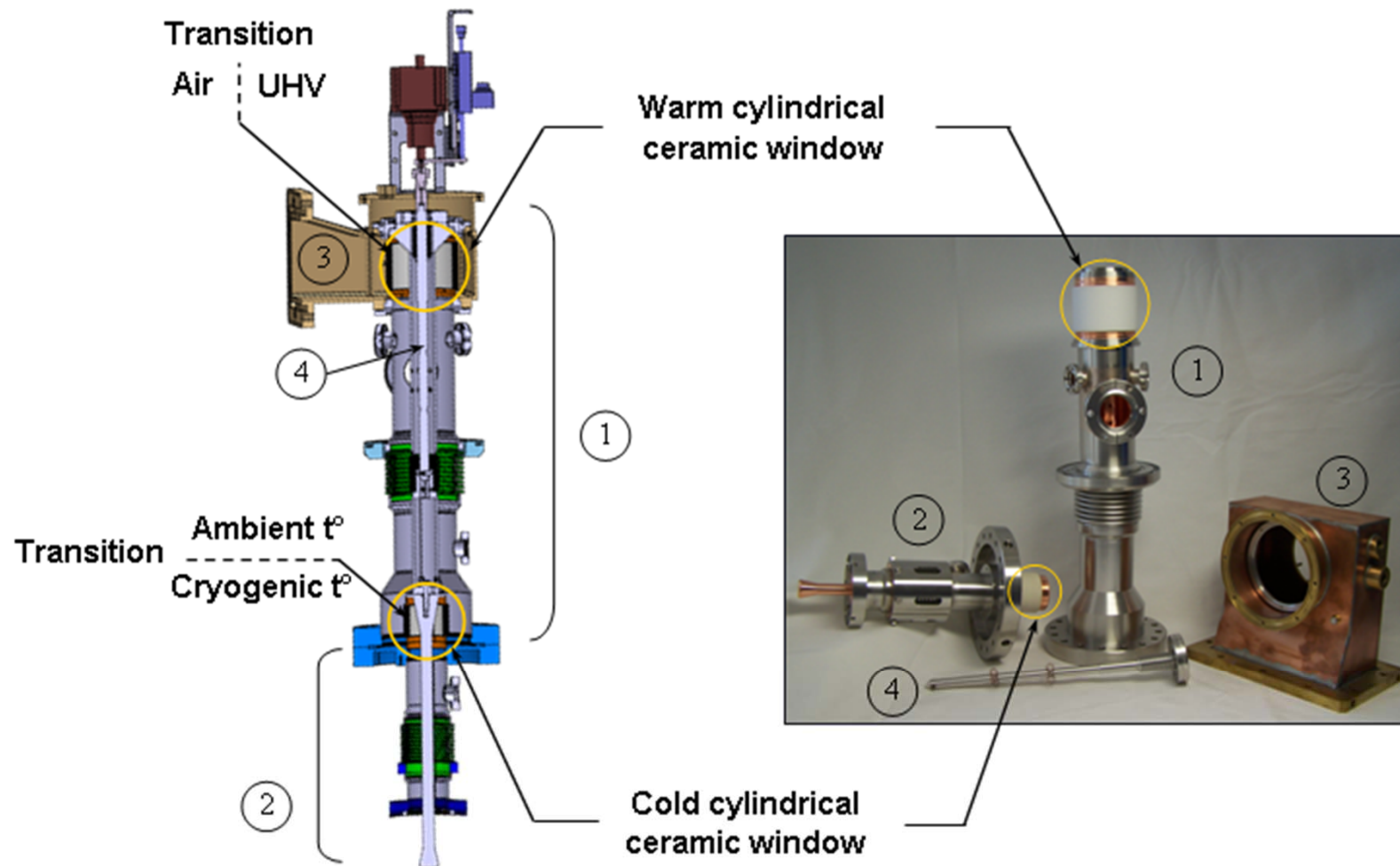

- ① Coupler warm part ② Coupler cold part ③ Wave guide transition ④ Tuning rode

At Thales site:

- 1st step: parts assemblies by brazing:



- 2nd step: copper plating of the assembled parts:

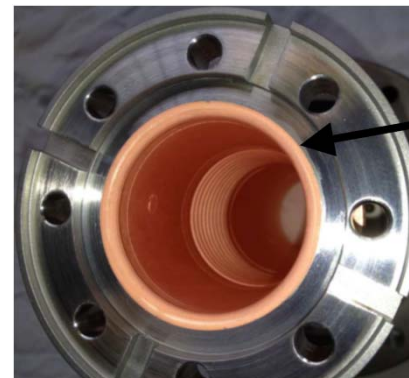



At RI site:

- Ceramics TiN coating,
- EB welding of ceramics in warm & cold parts,
- Cleaning of couplers in ISO5 clean room,
- Coupler assemblies by pairs in ISO4 clean room.



Shipment to LAL

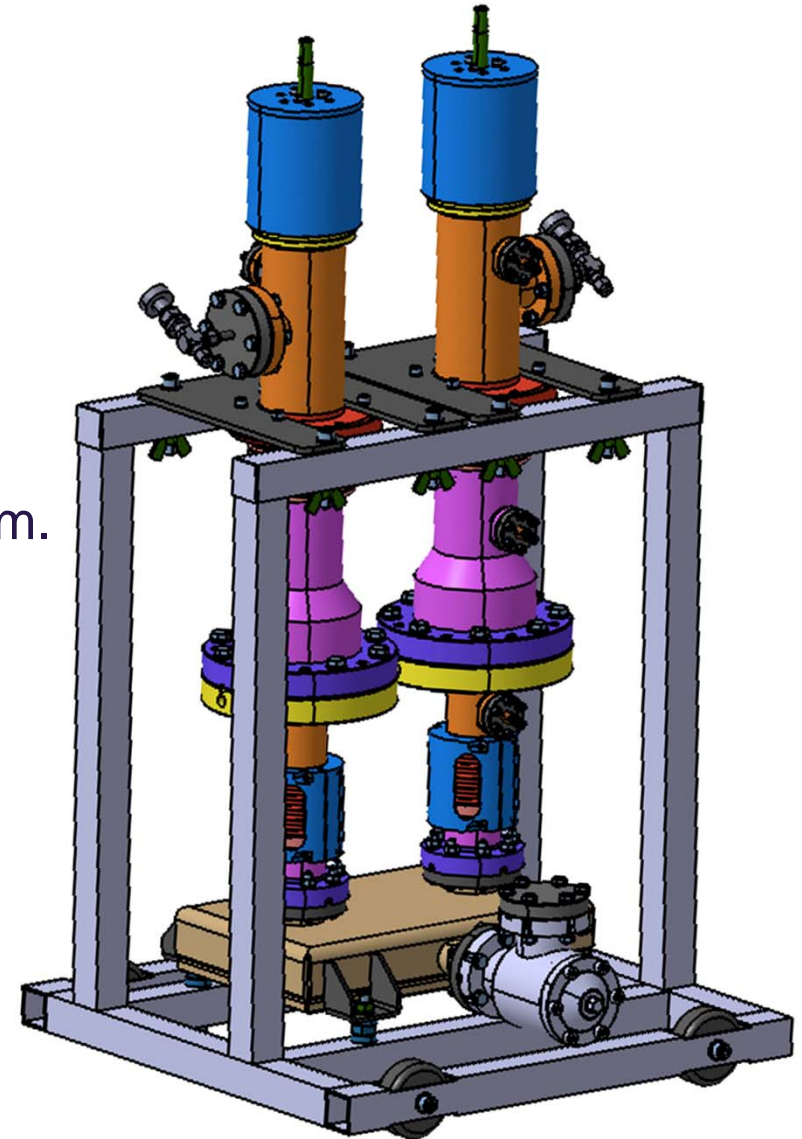



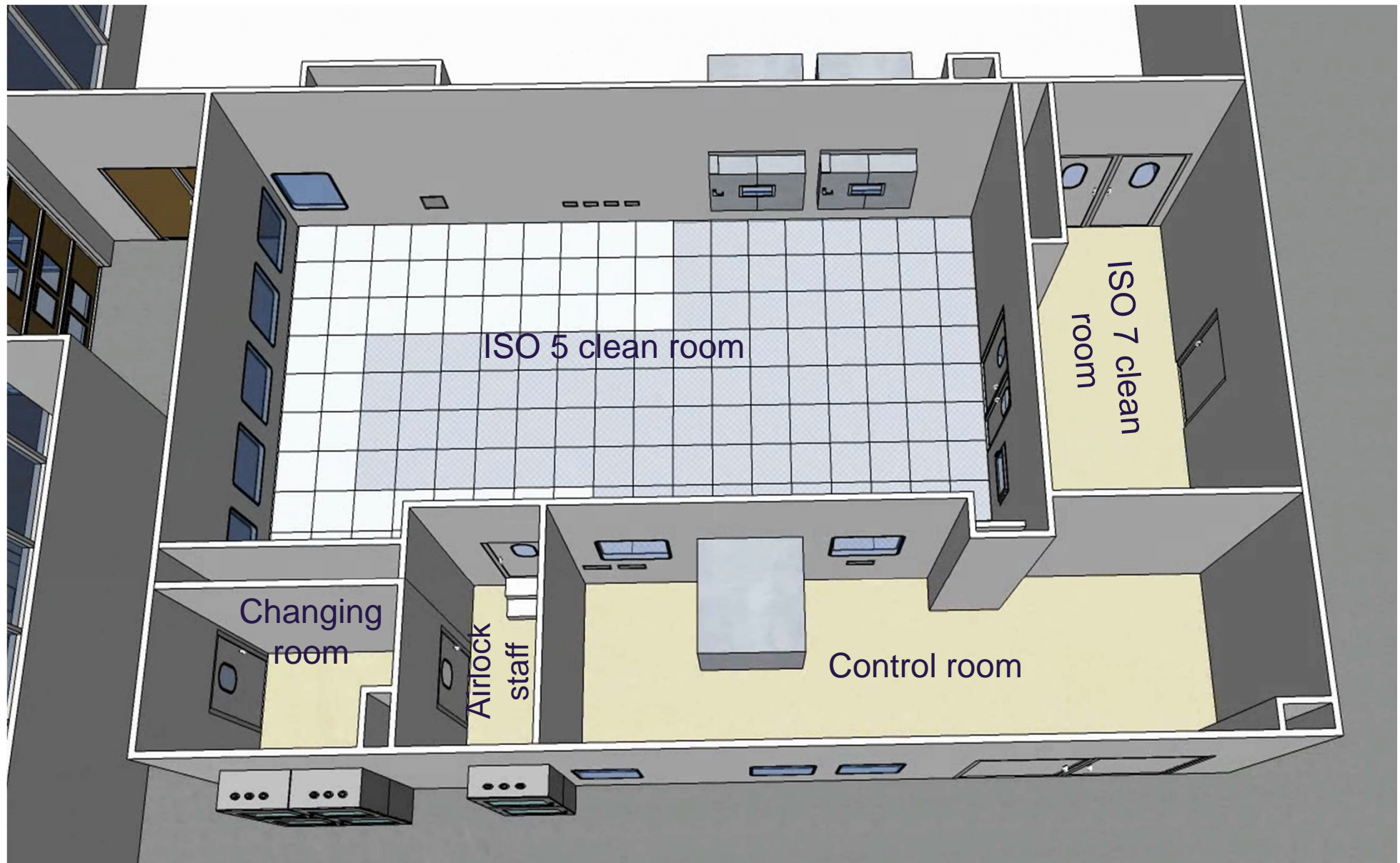









XFEL Coupler infrastructure at LAL

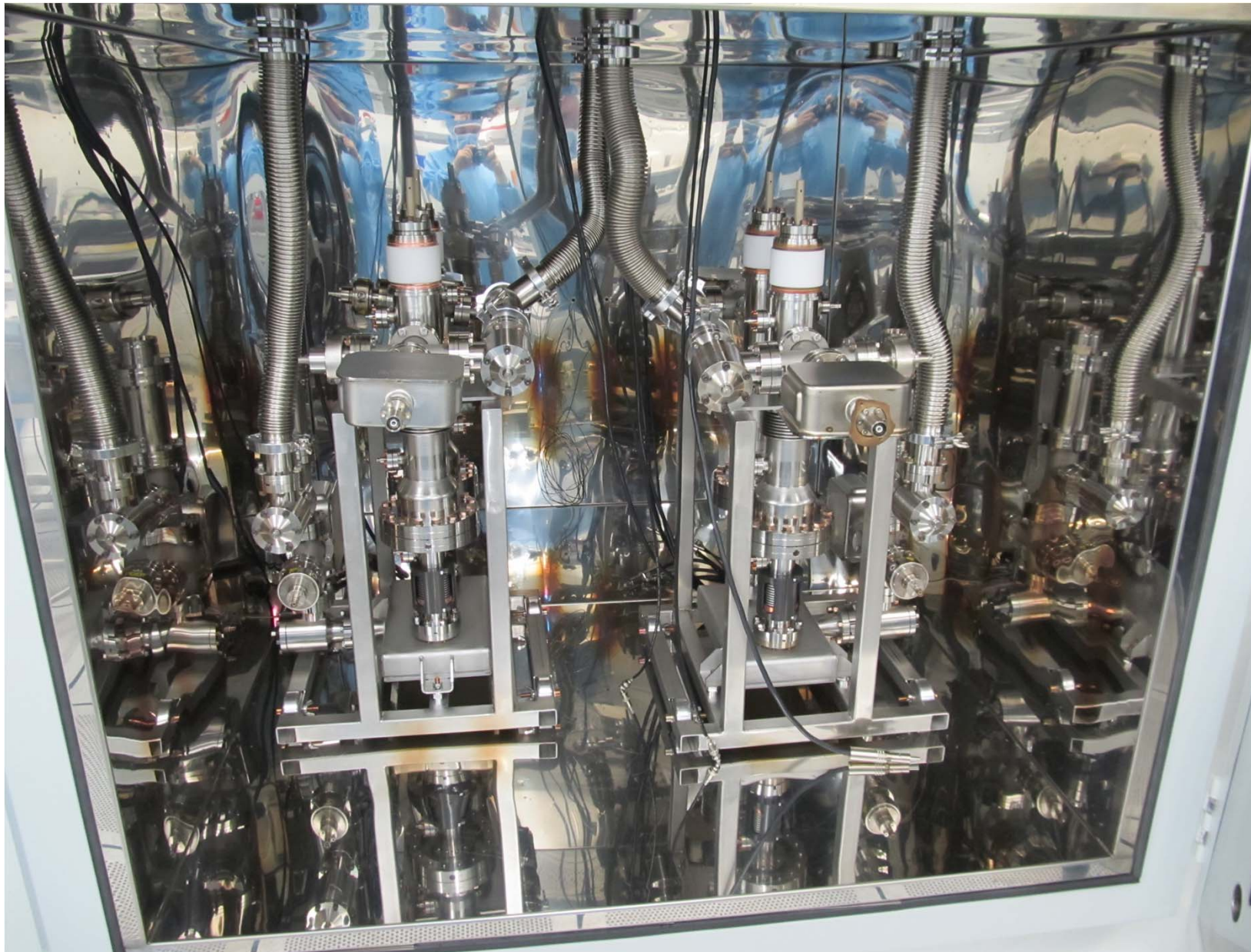

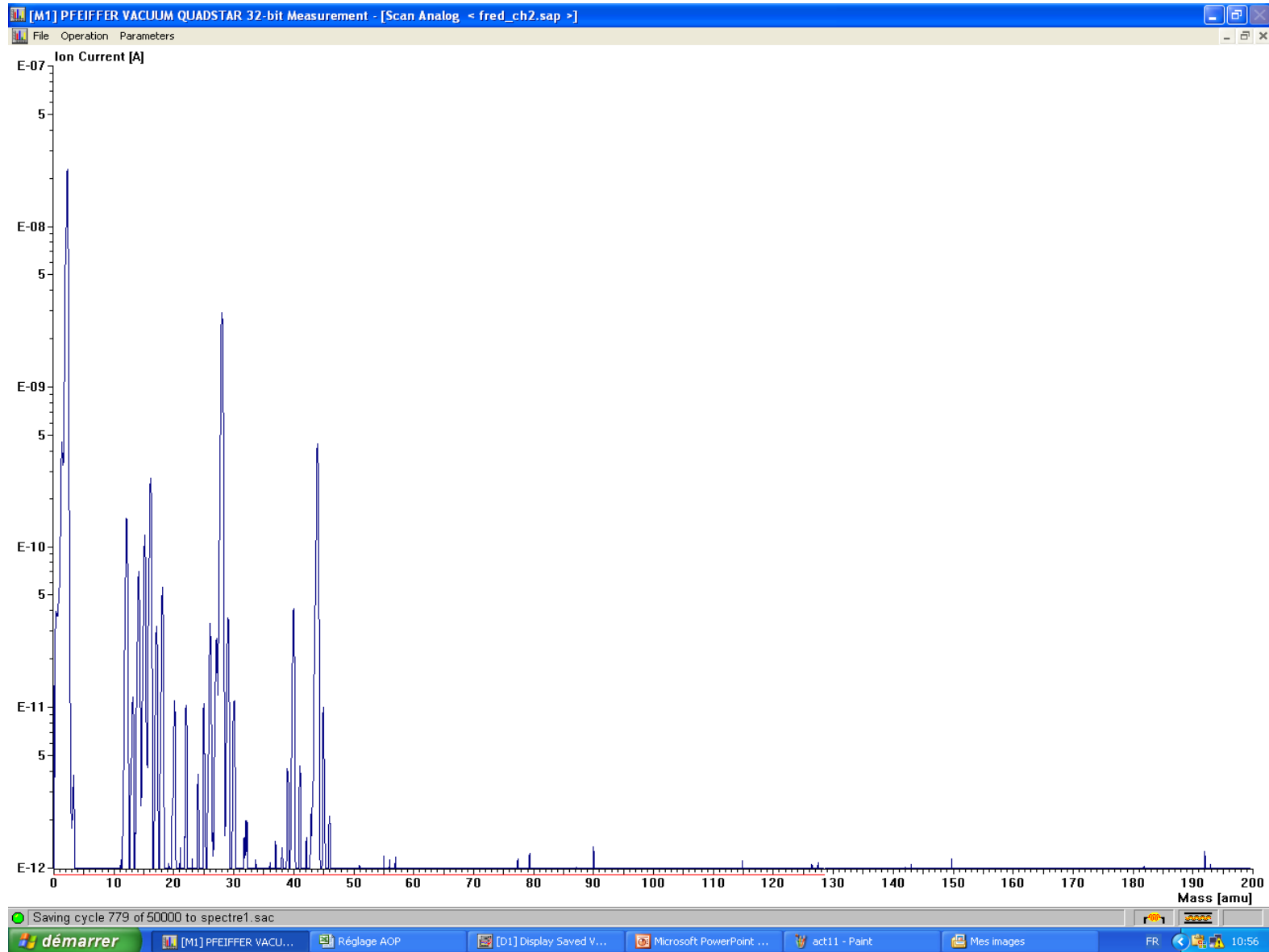

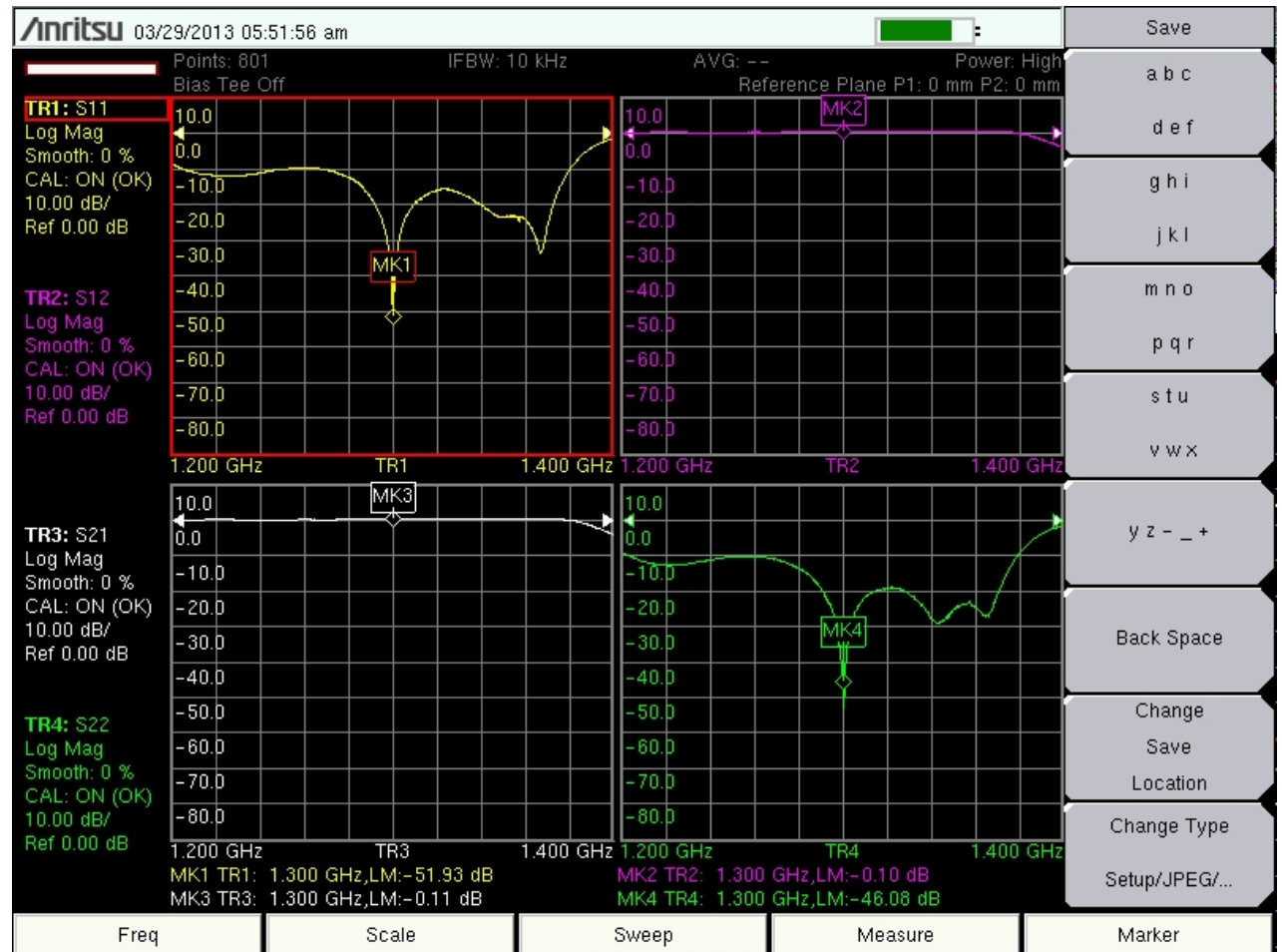
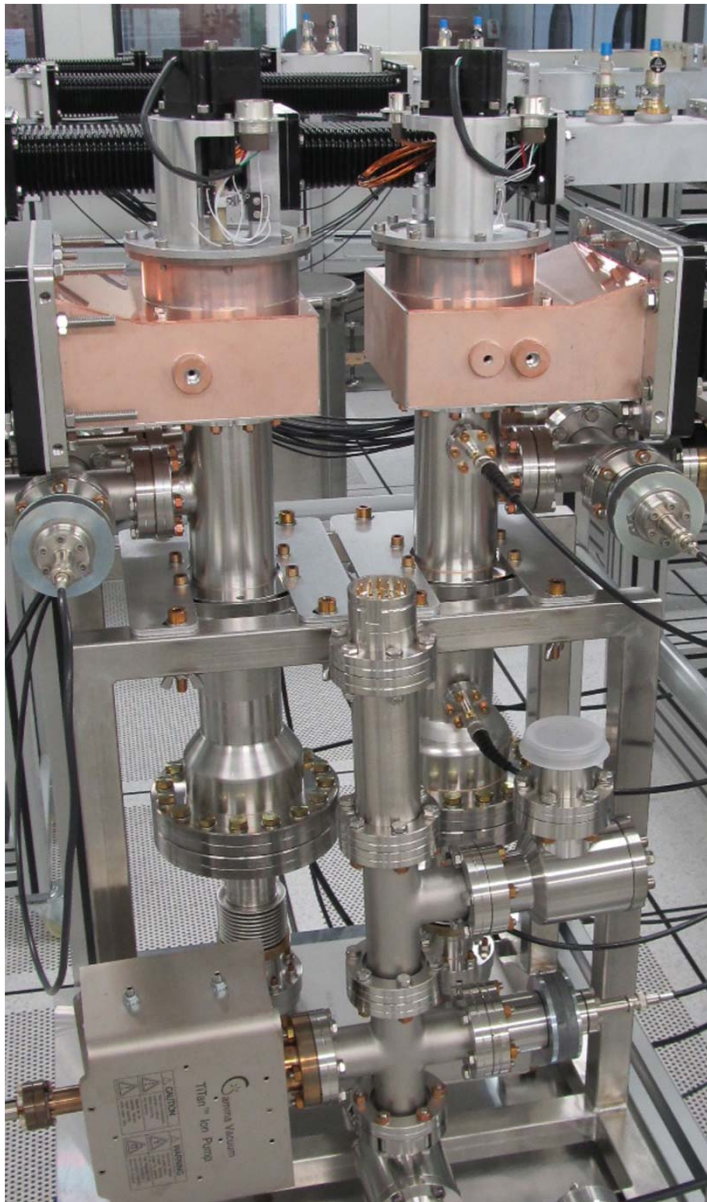

XFEL Coupler infrastructure at LAL

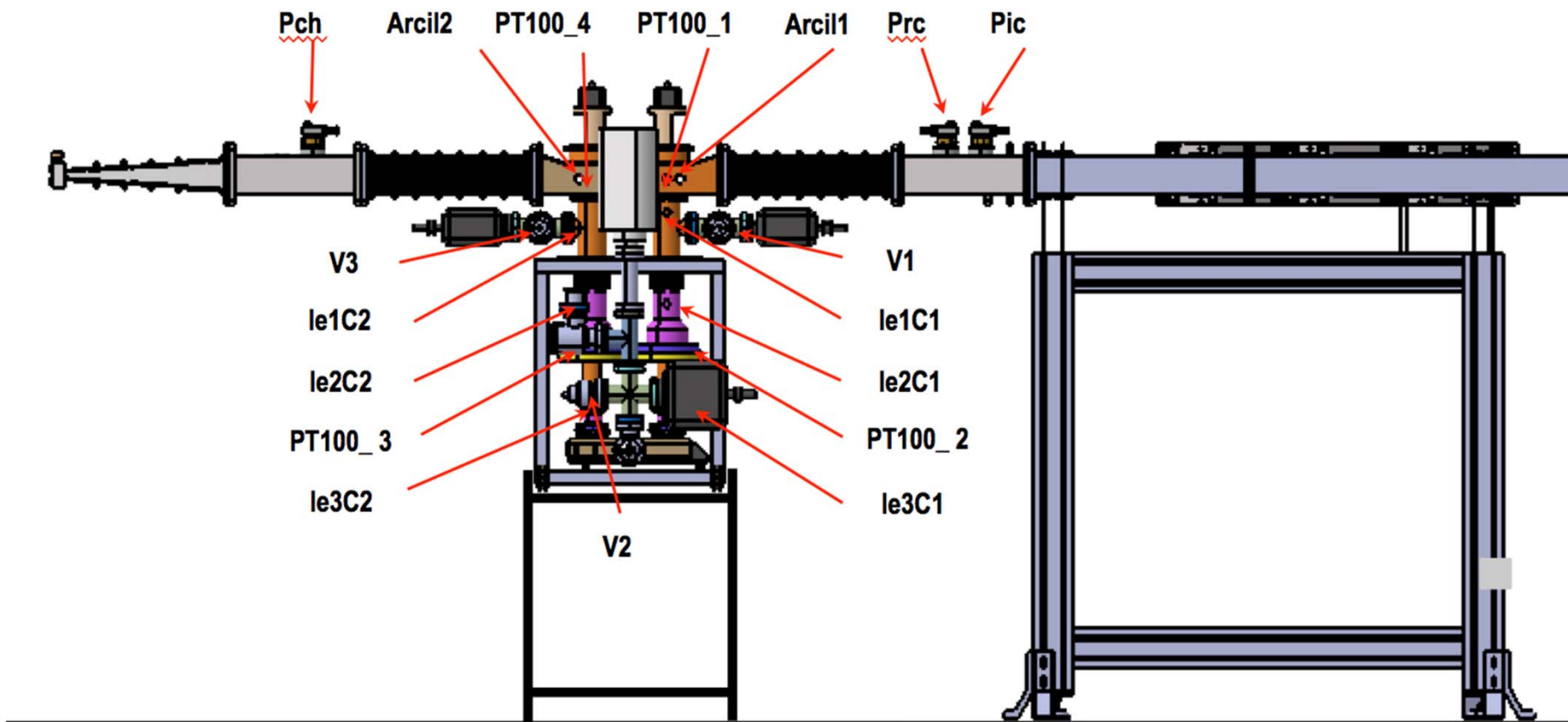



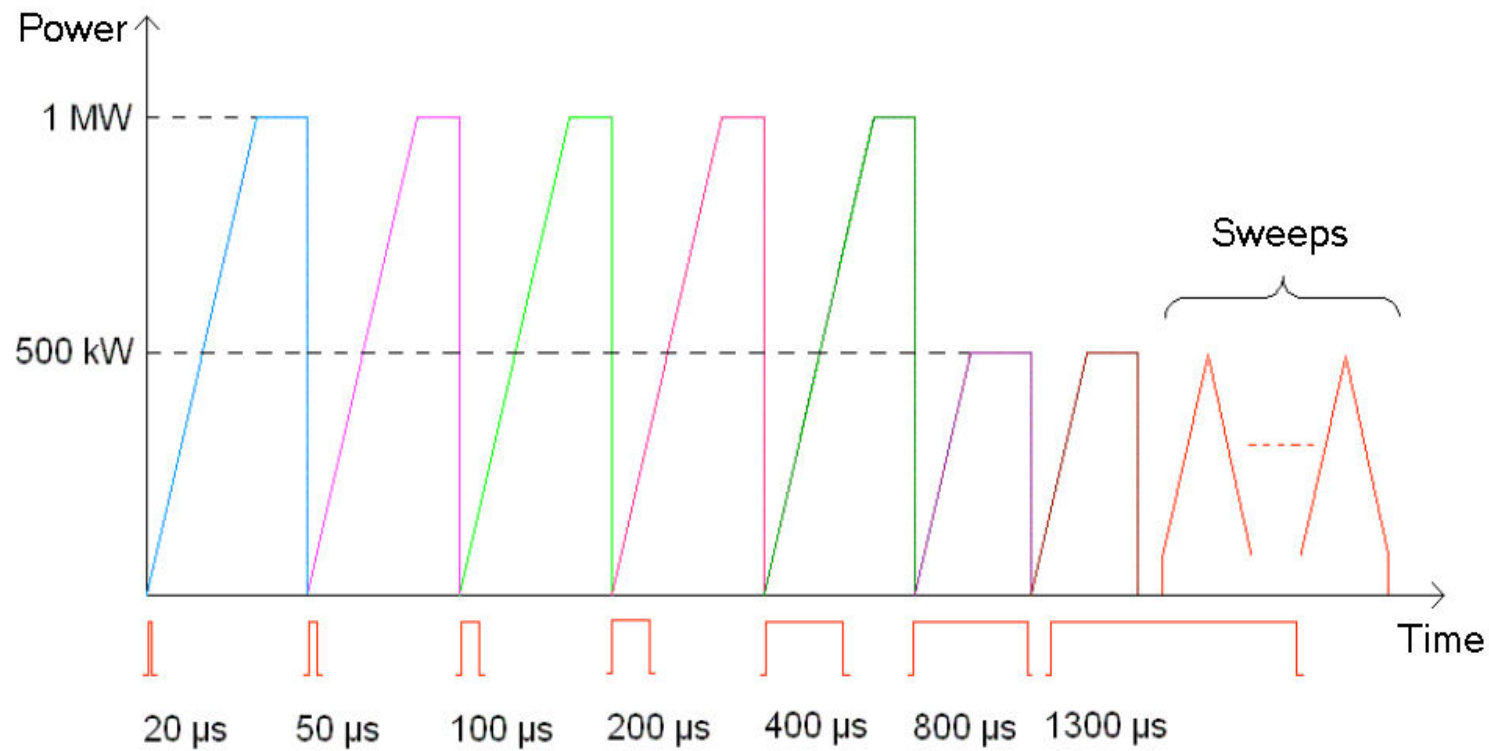

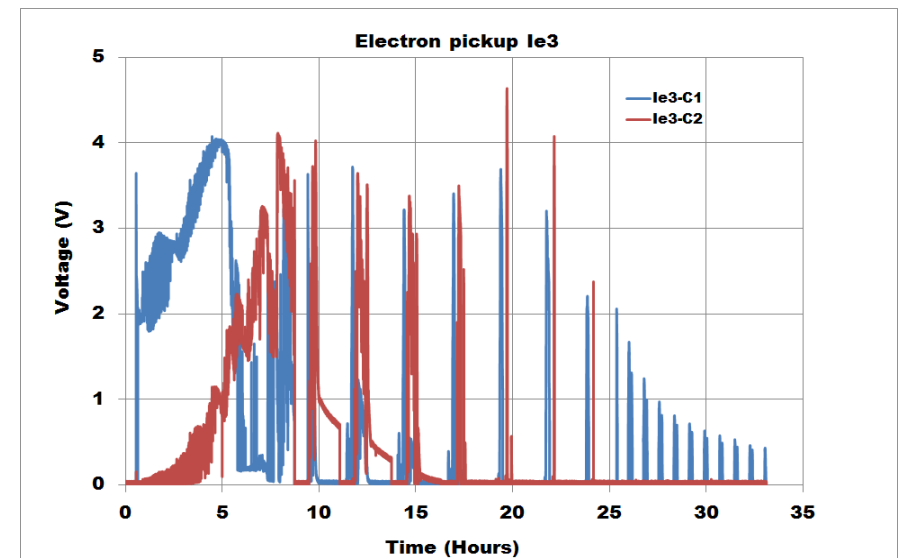
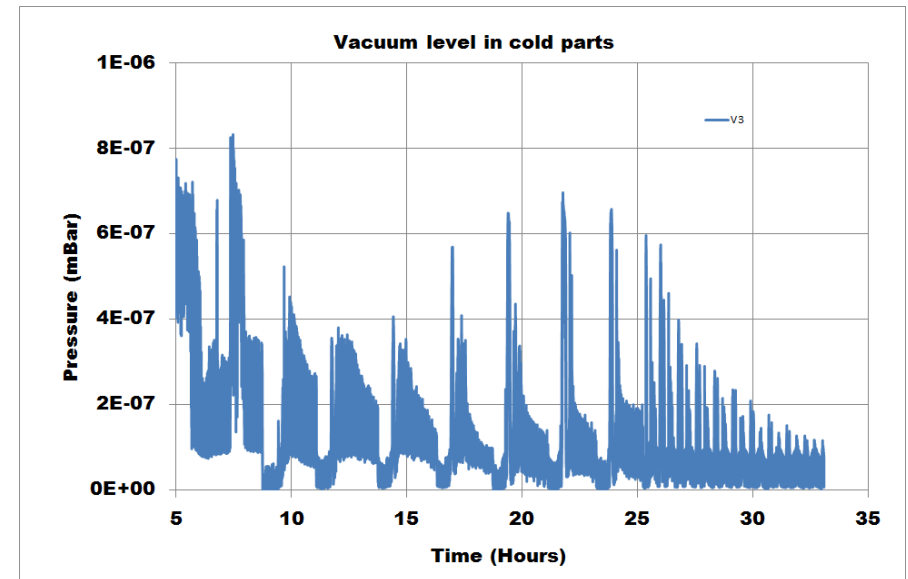
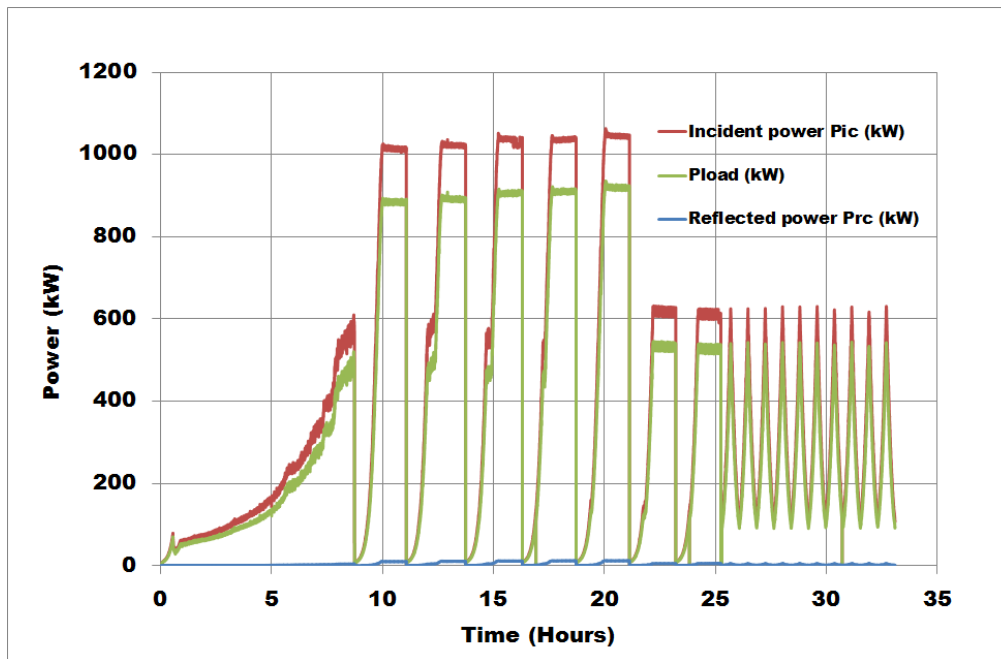









Thanks for your attention.

