

SPESO implantation at SOLEIL

Status of manufacturing

Transfer tool for the first grating

Proposal for gratings distributor

Schedule for the end of April

Conclusions and prospects

SPESO implantation at SOLEIL

ETALON – Implantation at SOLEIL

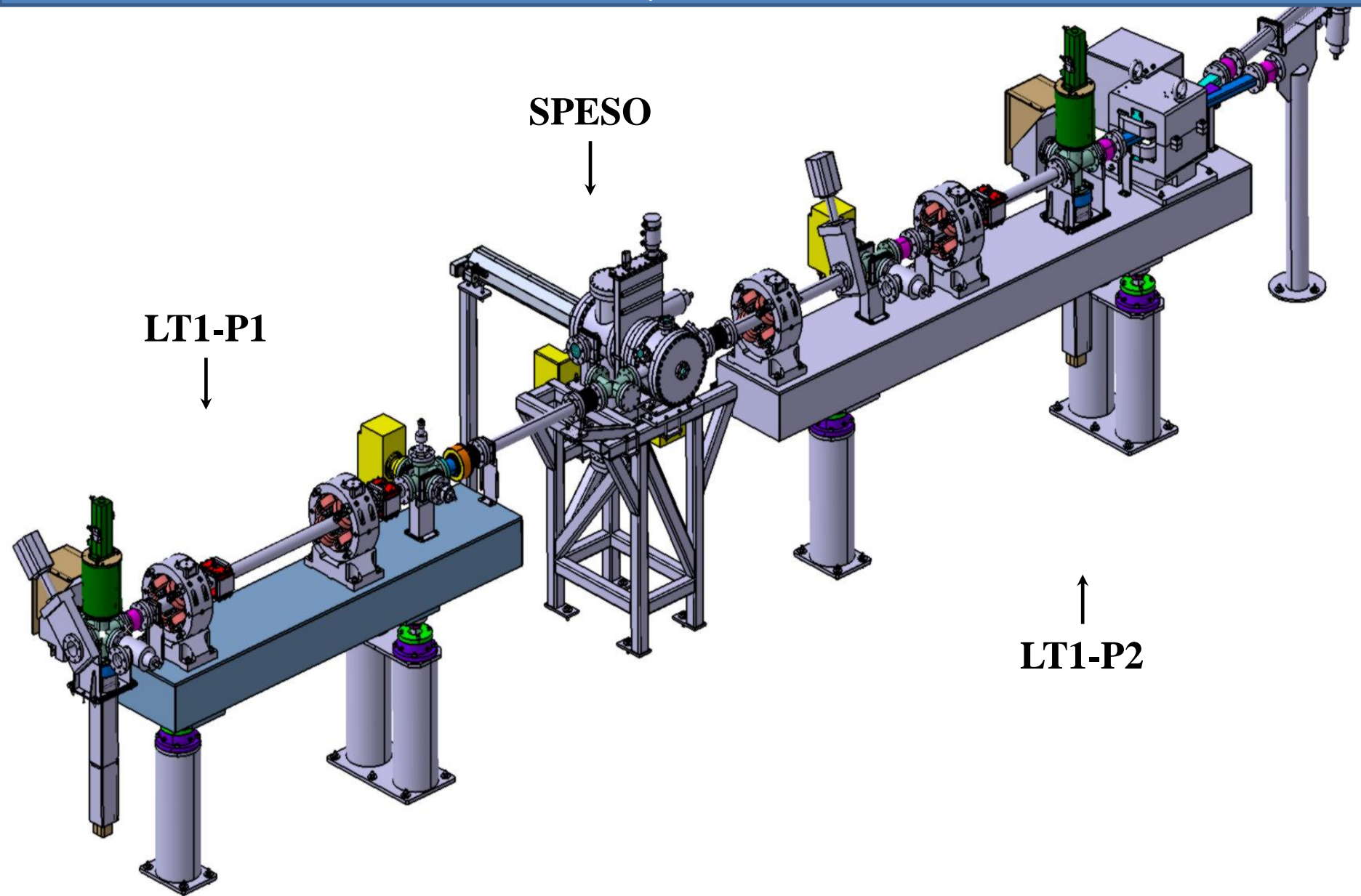

ETALON – Implantation at SOLEIL

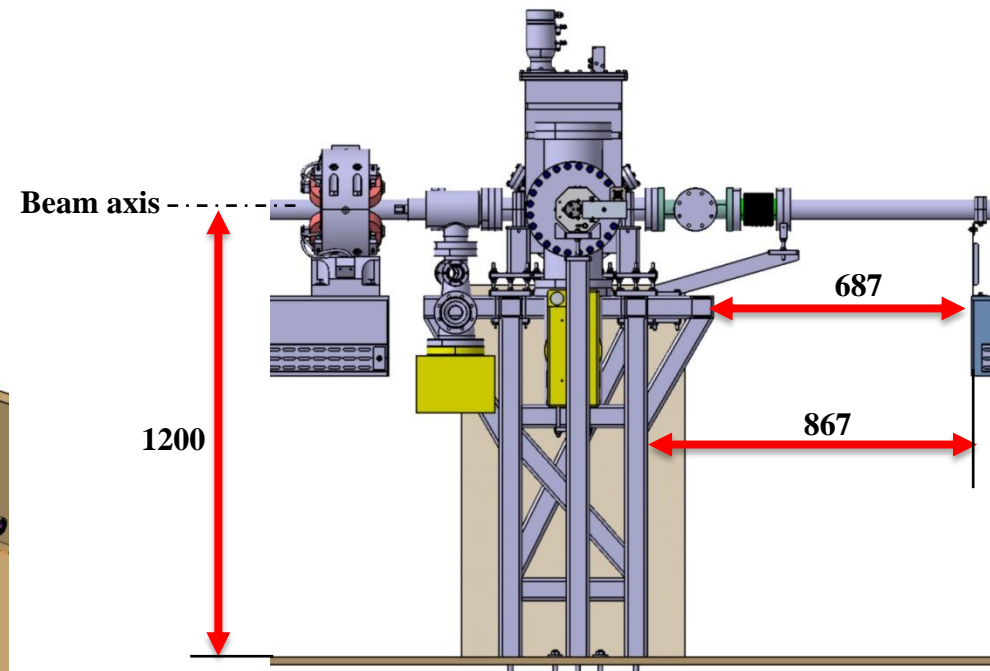
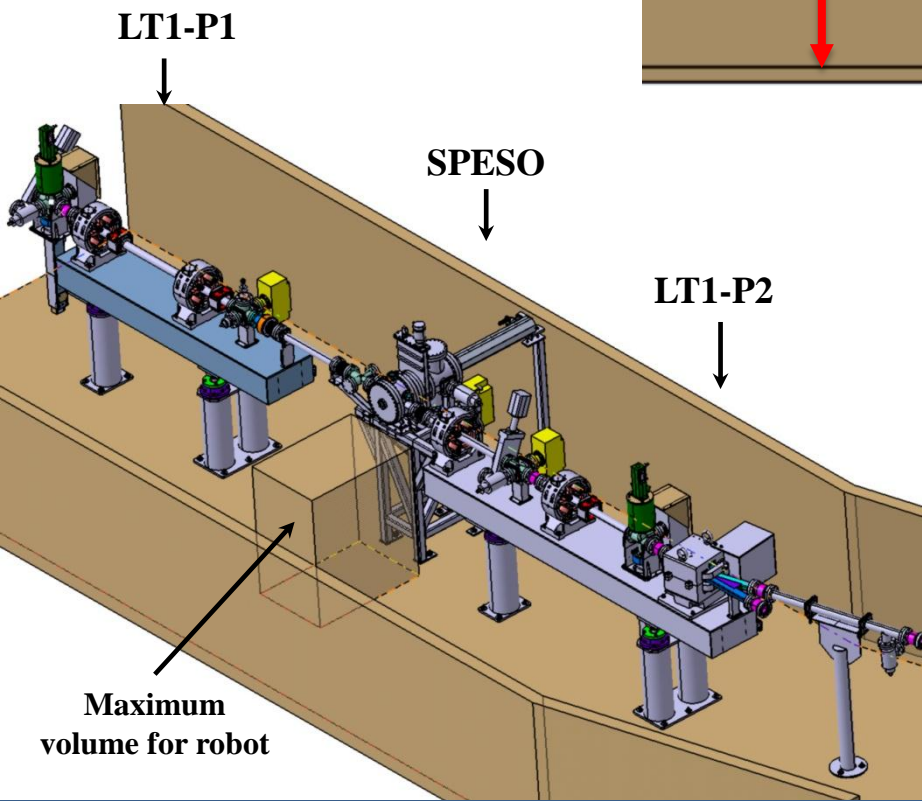
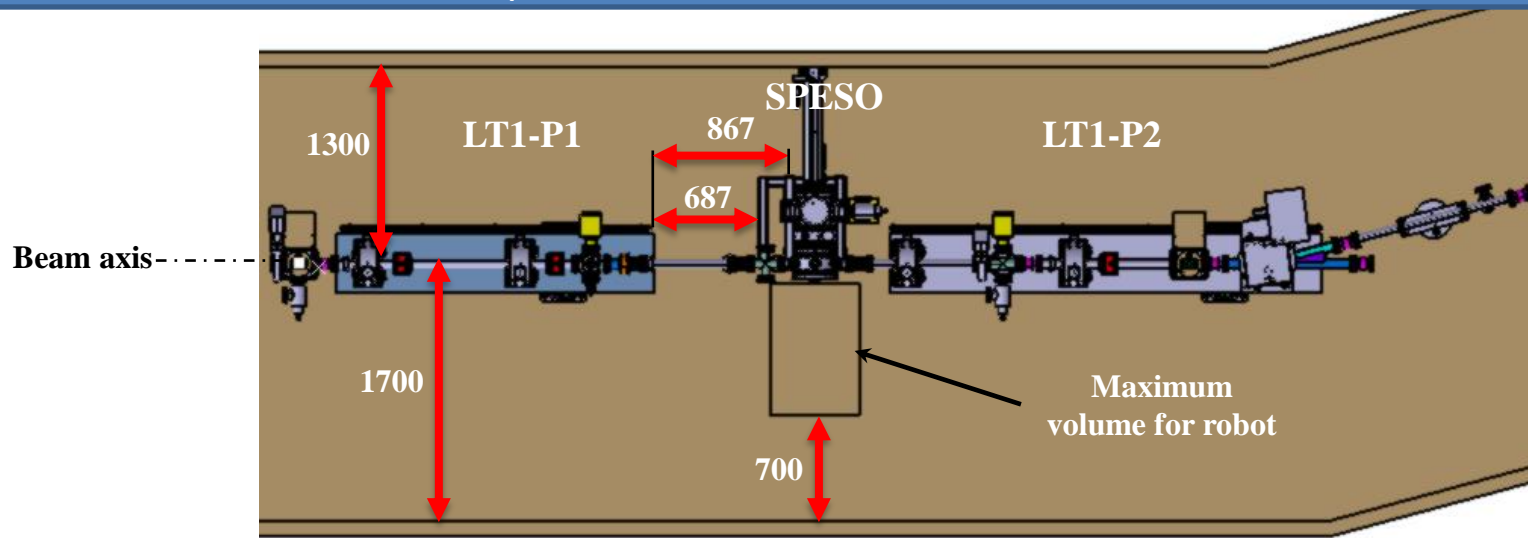

ETALON – Implantation at SOLEIL

Without SPESO

Drawing: I193EET001

Supply SOLEIL

Valve, bellows and pipe of 700 mm

Pipe holder

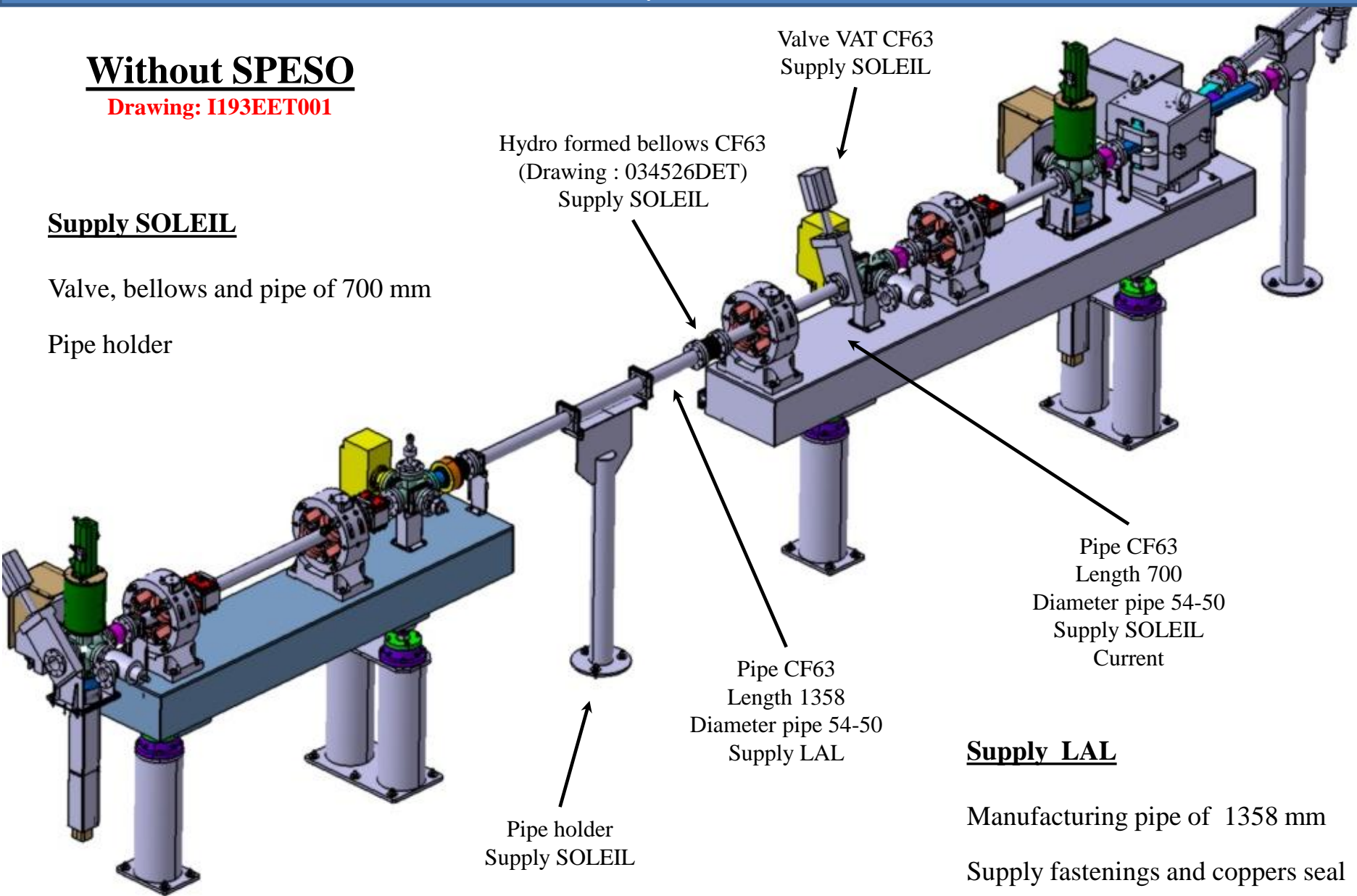

Hydro formed bellows CF63
(Drawing : 034526DET)
Supply SOLEIL

Valve VAT CF63
Supply SOLEIL

Pipe CF63
Length 700
Diameter pipe 54-50
Supply SOLEIL
Current

Pipe CF63
Length 1358
Diameter pipe 54-50
Supply LAL

Pipe holder
Supply SOLEIL

Supply LAL

Manufacturing pipe of 1358 mm

Supply fastenings and coppers seal

Status of manufacturing

ETALON – Status of manufacturing

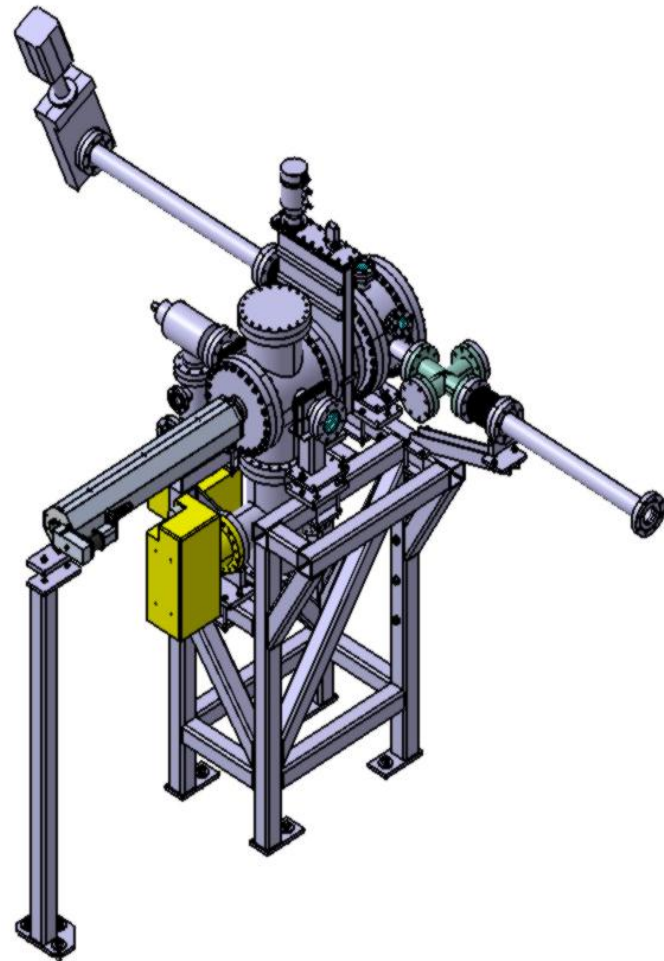

SPESO with the transfer tool

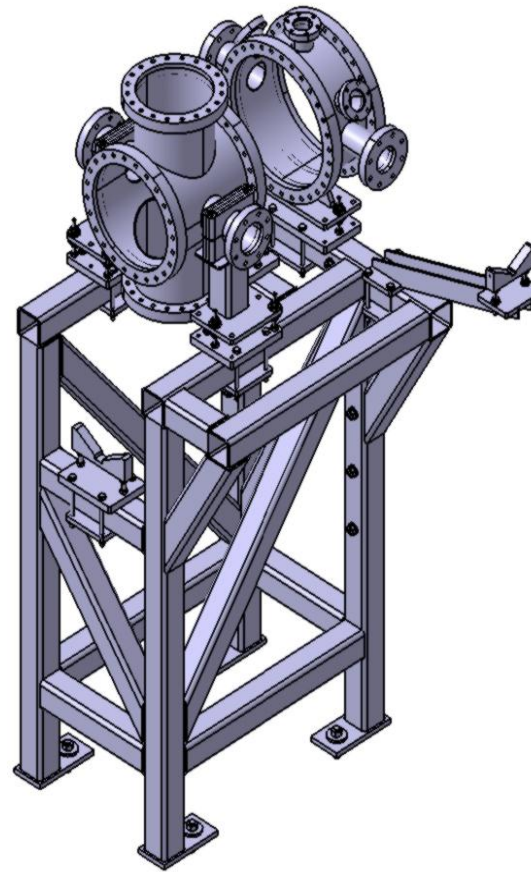

**Two chambers are supported
and with adjustable tilt
CAV1 and CAV2**

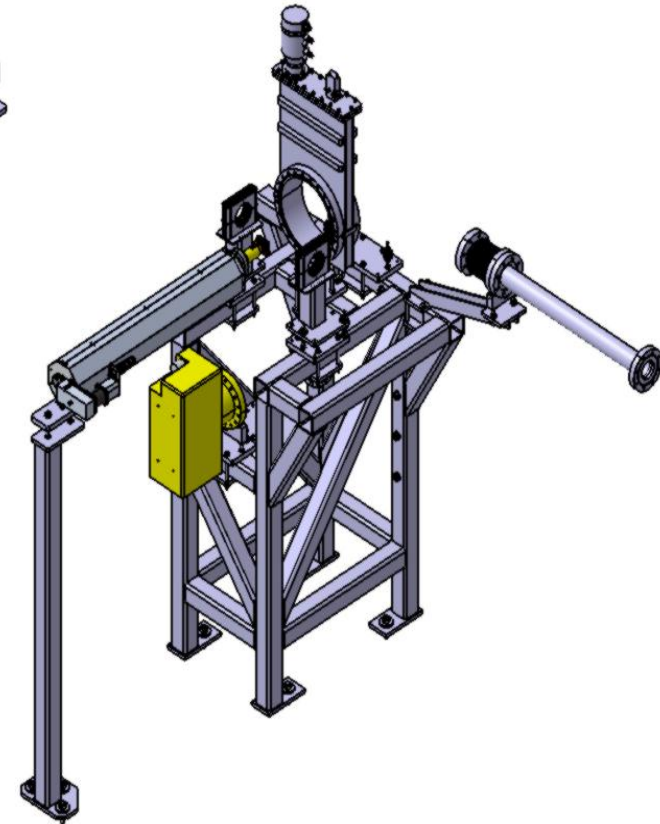

**Transfer tool, pump, valve HVA
and bellows are supported**

ETALON – Status of manufacturing

Drawing folder is finished

VACUM for manufacturing

- Cav1
- Cav2
- Flat adaptor
- Adaptor
- Two think four branch
- Two pipes

Reception : 2nd April

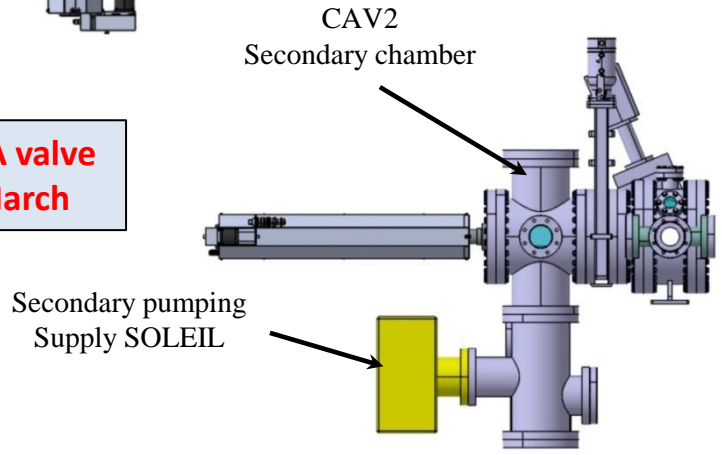
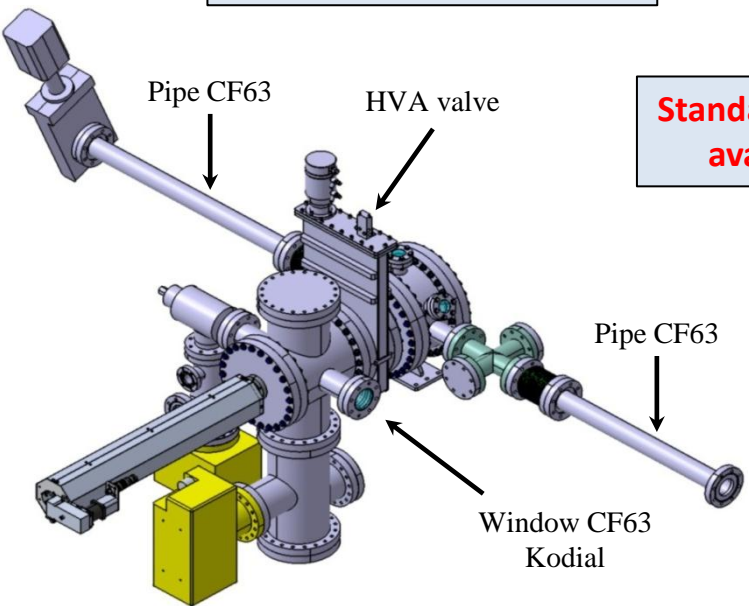
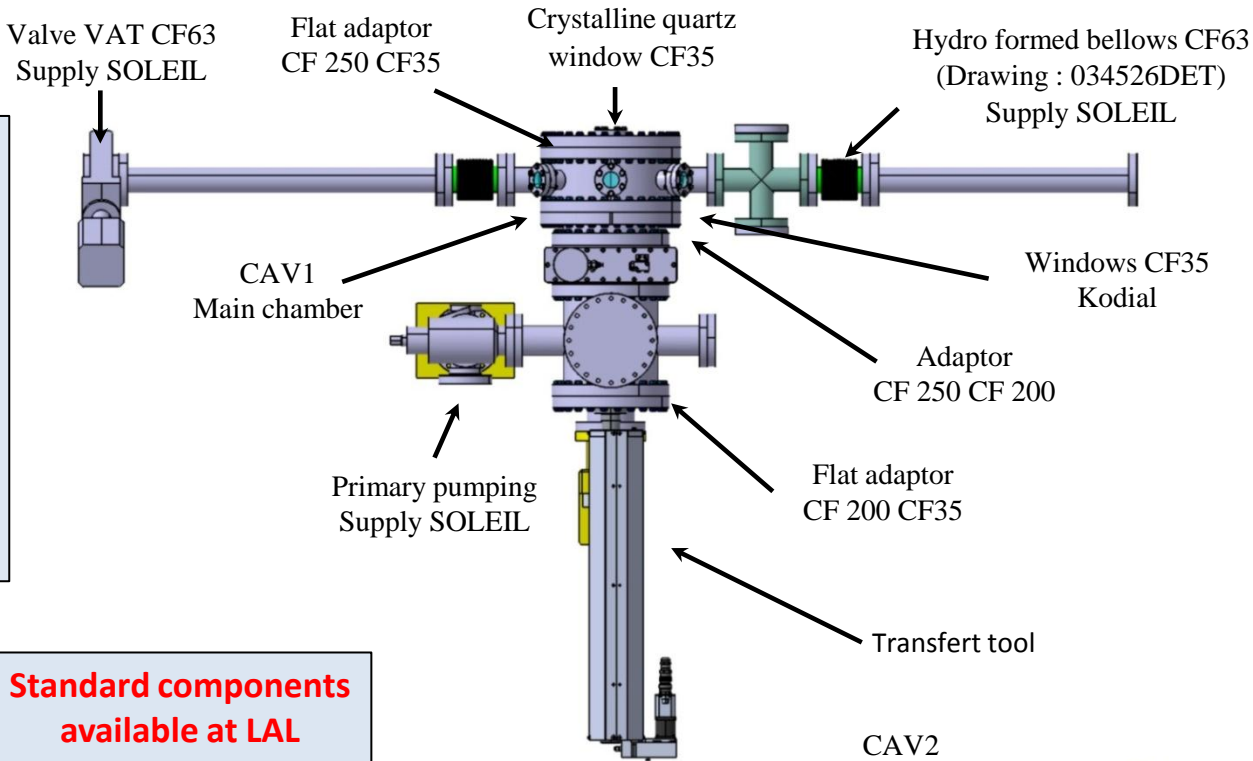

ETALON – Status of manufacturing

Drawing folder is finished

Manufacturing at LAL

Reception : end of Mars

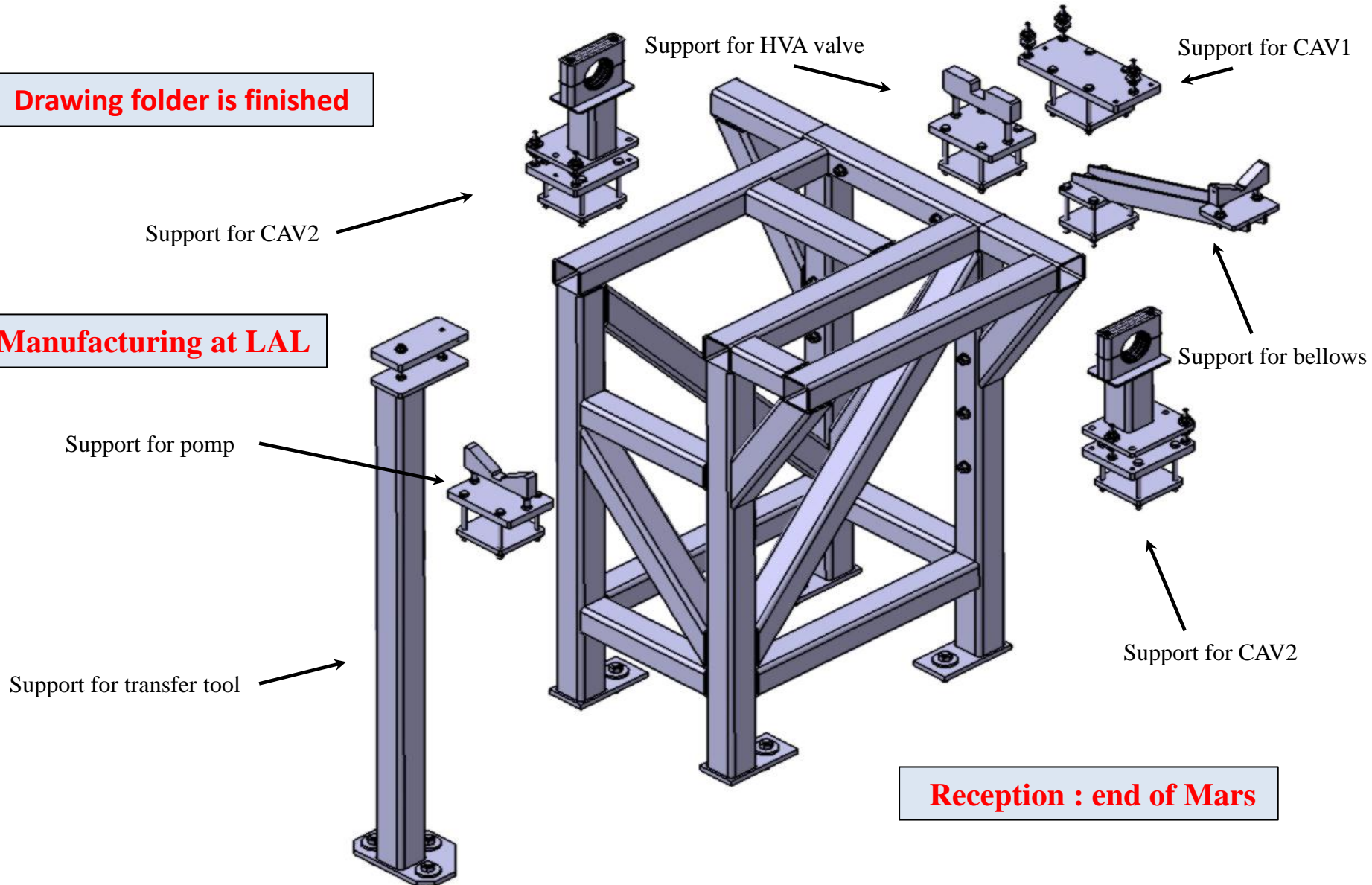

Transfer tool for the first grating

ETALON – Transfer tool for the first grating

Transfert tool

Maximum transfer
457 mm

Grating in front
of the beam

Grating in CAV2 after the valve
Possibility of change the grating

Proposal for fastening a gratings on transfer tool

Manufacturing of grating in workshop at LAL with wire cutting machine

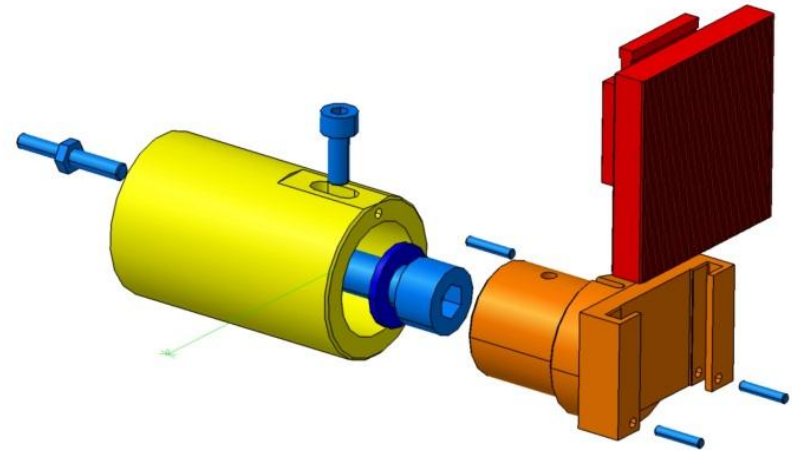
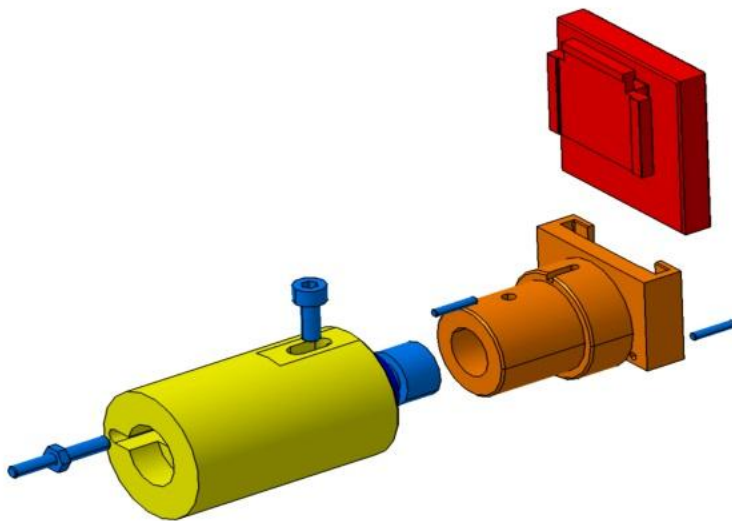
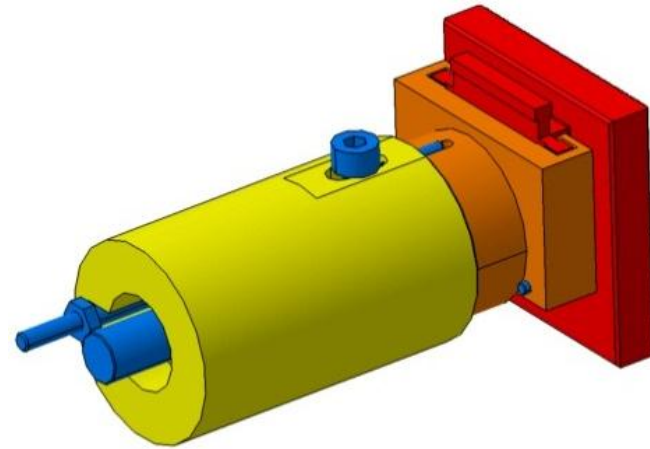

Proposal for gratings distributor

ETALON – Proposal for gratings distributor

**Proposal for a carousel in rotate
 presenting eight different gratings**

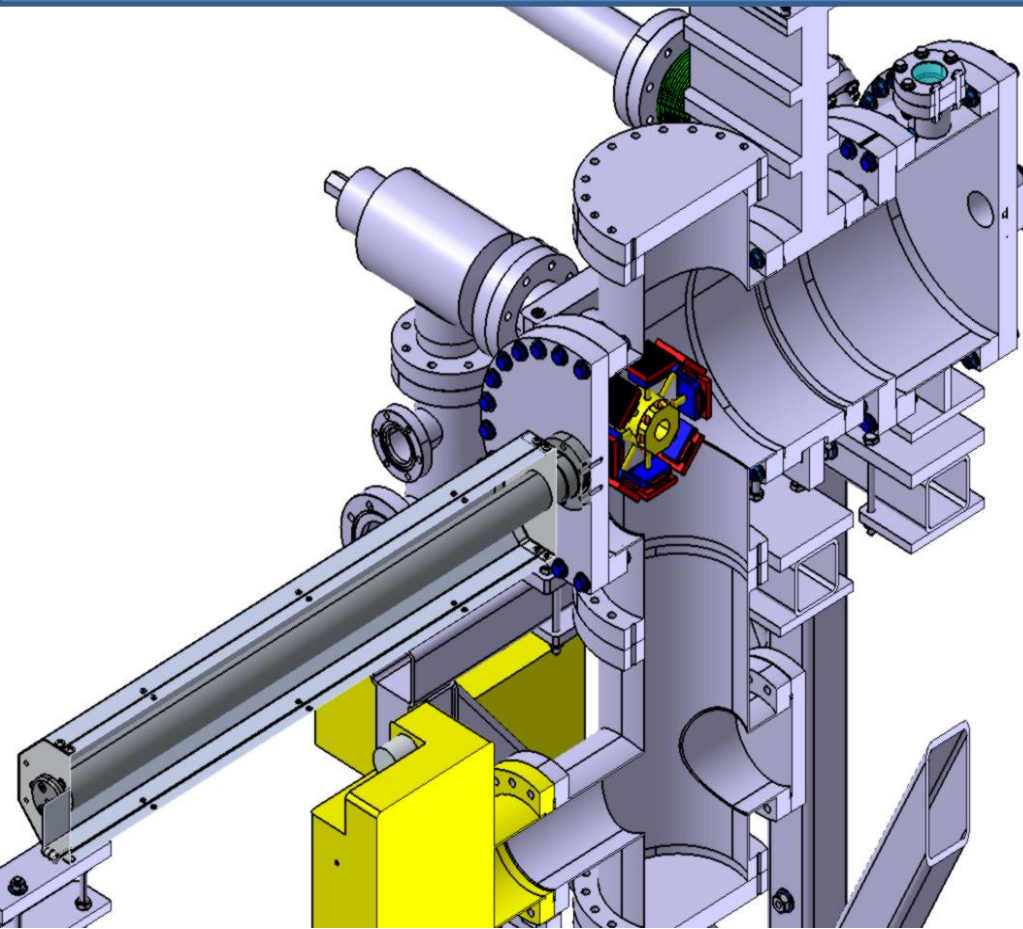

Carousel in CAV2 after the valve
 Possibility of change the carousel

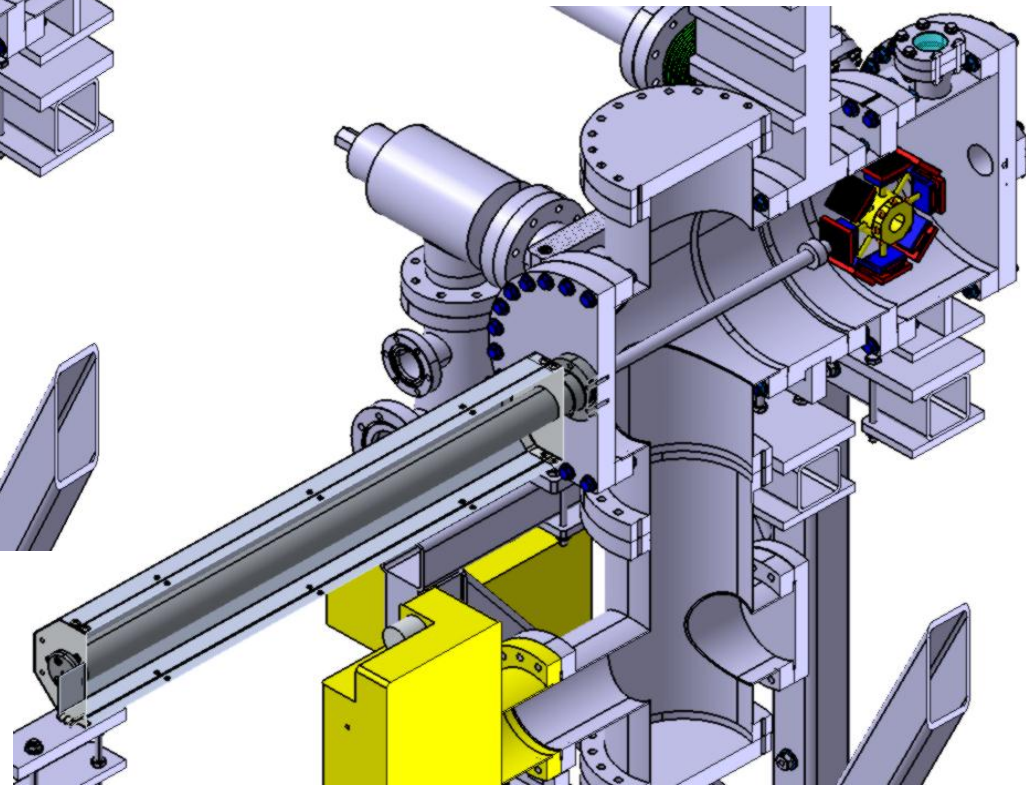

Carousel in front of the beam

Schedule for the end of April

ETALON – Schedule for the end of April

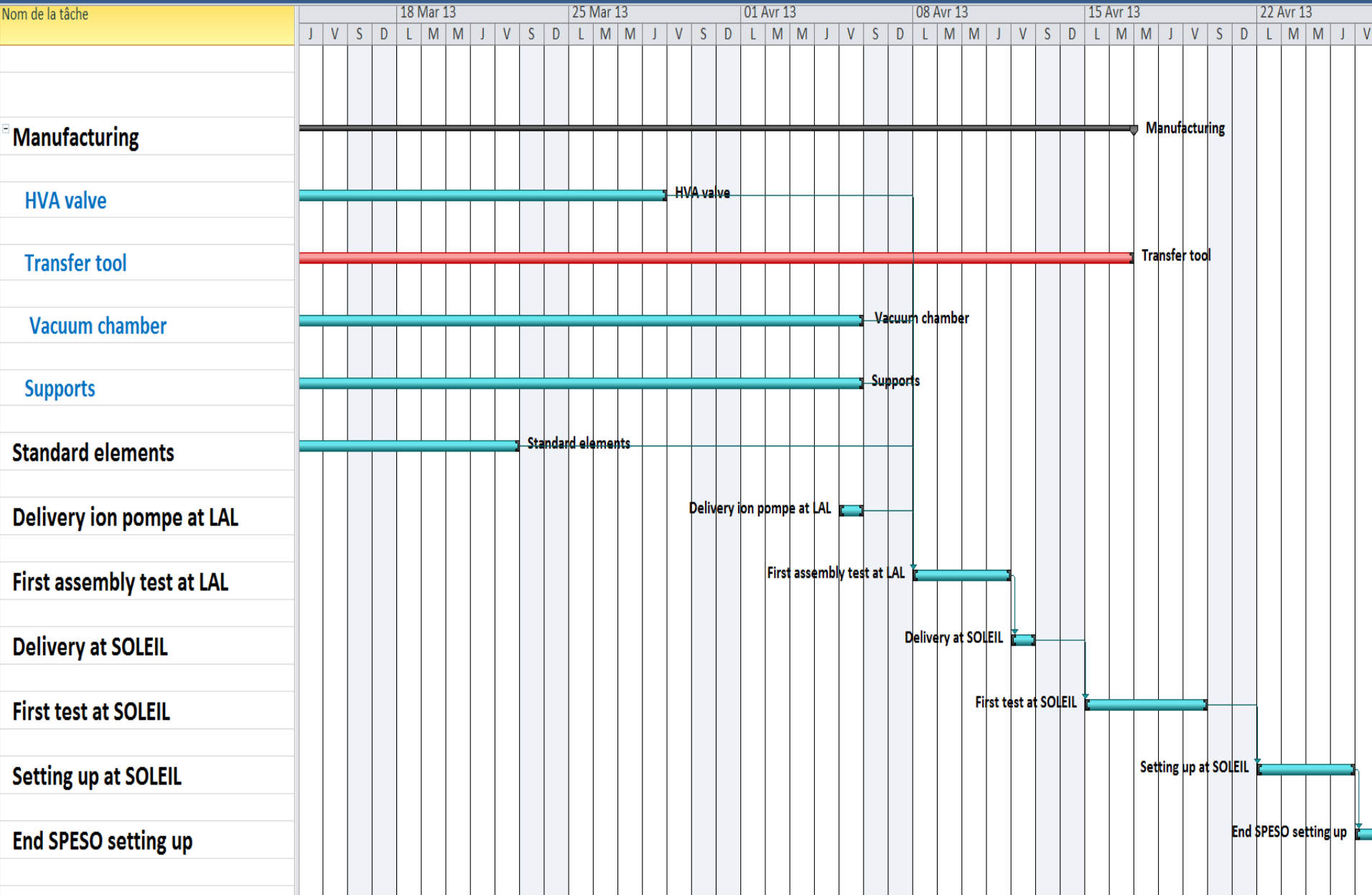

Conclusions and prospects

Installation of a temporary system for the SP radiation detection

Start of the first measurements for SPESO at May

Study and set up of cameras on windows

Study and set up of quartz on windows DN 250

Study and set up of a robot and filters for the SP radiation detection

Proposals for others gratings (geometry and fastening)

Proposals for others scenario for the gratings distribution

With a second transfert tool, for example